

BRIGHTON & HOVE CITY COUNCIL

ANTI-SOCIAL BEHAVIOUR, CRIME AND POLICING ACT 2014

BRIGHTON & HOVE CITY COUNCIL (NELSON ROW) PUBLIC SPACES PROTECTION ORDER 2023

Brighton & Hove City Council in exercise of its powers under sections Section 59, 64 and 72 of the Anti-social Behaviour, Crime and Policing Act 2014 ("the Act") hereby makes the following Order:-

1. This Order shall come into operation on xx xxxxxxxxxxxx xxxx and shall have effect until XXXXXXXXXXXX unless extended before that date under the Council's statutory powers.
2. This Order relates to that part of the public highway known as Nelson Row as is shown coloured green on the attached plan ("the Restricted Area"). This forms the rear access to residential flats in the Milner block and access to the Puffin Community Nursery and Millwood Community Centre
3. This Order authorises that entry to the Restricted Area ("the Restricted Area") is restricted by the erection of gates at both ends of the Restricted Area ("the Gates"). The gates shall each include a vehicle entry which shall be locked at all times except as required for service or emergency access and a pedestrian entry which shall remain unlocked.
4. The effect of the order will be to restrict the passage of through traffic including motorcycles and to provide protection for residents by reducing the use of the area by antisocial or disorderly individuals and groups and forming a barrier between the estate walkways and Kingswood Street offering protection to children from road danger, whilst retaining pedestrian access through the restricted area and to properties within it.
5. The alternative route for vehicles including motorcycles will be via the carpark entrance on Morley Street.
6. Locking and unlocking the Gates to facilitate emergency or service vehicle access will be carried out by key-holding residents of the Restricted Area or staff from the Puffin Nursery. The vehicle gates will be locked with a standard BHCC key which service staff and emergency services will be able to access as required.
7. As the restricted area – as well as forming public highway – is a part of the estate grounds, all areas will continue to be managed by BHCC Housing as at present.
8. The Council is satisfied that the conditions set out in Sections 59, 64 and 72 of the Act have been satisfied and that it is in all the circumstances expedient to make this Order for the purposes of reducing crime and antisocial behaviour in and around the Restricted Area. The Council makes the Order because criminal and antisocial behaviour in and around the Restricted Area has had a detrimental effect on the quality of life of those in the locality. The effect or likely effect of this is of a persistent or continuing nature such as to make this unreasonable, and justifies the restrictions imposed by this Order.
9. If any interested person desires to question the validity of this Order on the grounds that the Council had no power to make it or that any requirement of the Act has not been complied with in relation to this Order, he or she may apply to the High Court within six weeks from the date on which this Order is made.

Made under the Common Seal of

Brighton & Hove City Council

this ... day of 2023



The Common Seal of Brighton & Hove City Council was affixed to this Order in the presence of

.....

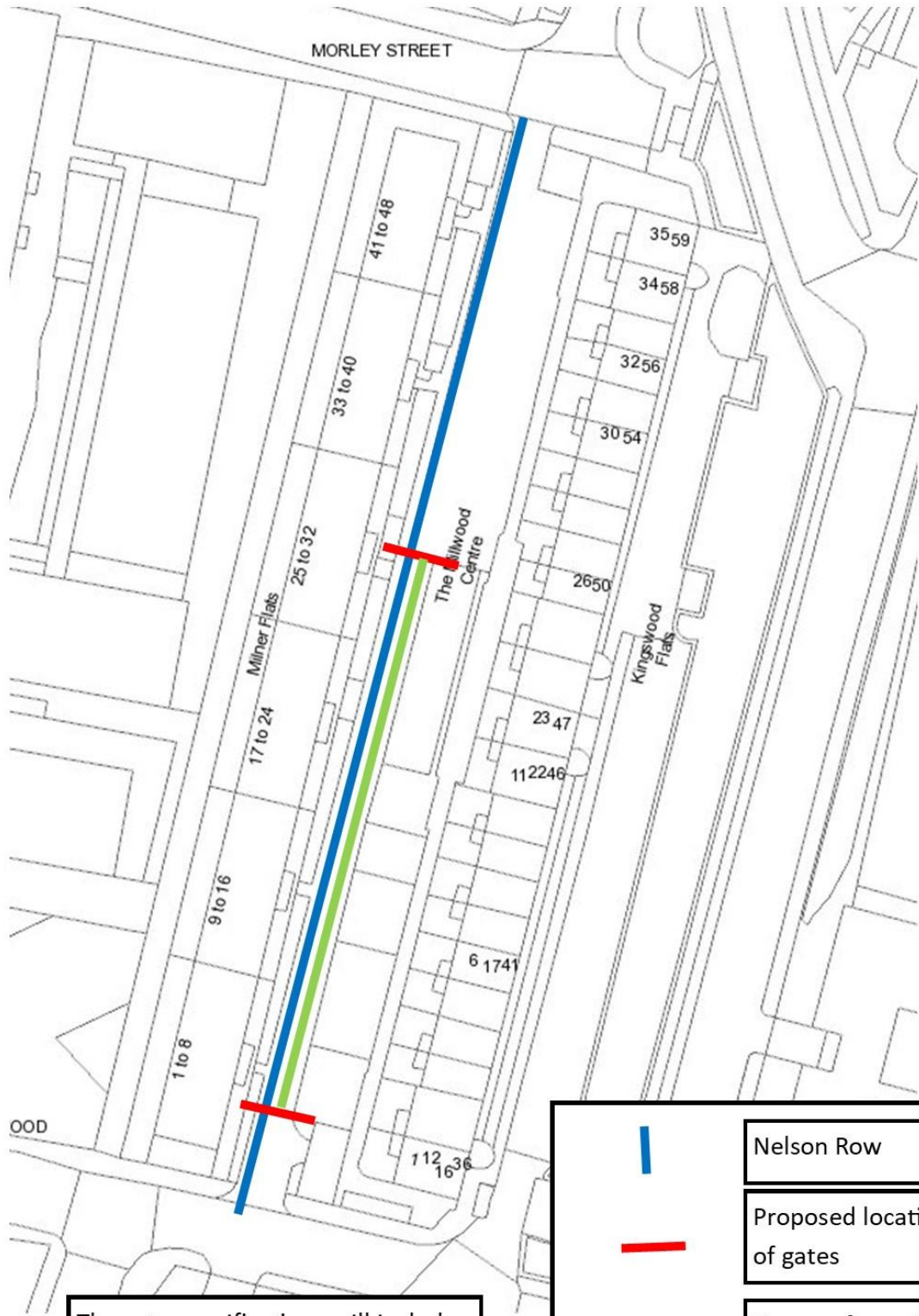
Authorised Officer



The gate specifications will include a lockable vehicle gate and an unlocked pedestrian gate with closer.

| | |
|--|----------------------------|
|  | Nelson Row |
|  | Proposed location of gates |
|  | Extent of restricted area |